



User's Manual

Toot-Toot Drivers Drive & Discover Police Car



© 2016 VTech
All rights reserved
Printed in China
91-003302-001 

VTech understands that a child's needs and abilities change as they grow and with that in mind we develop our toys to teach and entertain at just the right level...

vtech Baby

Toys that will stimulate their interest in different textures, sounds and colours

I am...

...responding to colours, sounds and textures

...understanding cause and effect

...learning to touch, reach, grasp, sit-up, crawl and toddle

Birth-36 months



Pre-School

Interactive toys to develop their imagination and encourage language development

I want...

...to get ready for school by starting to learn the alphabet and counting

...my learning to be as fun, easy and exciting as can be

...to show my creativity with drawing and music so my whole brain develops

3-6 years



Electronic Learning Computers

Cool, aspirational and inspiring computers for curriculum related learning

I need...

...challenging activities that can keep pace with my growing mind

...intelligent technology that adapts to my level of learning

...National Curriculum based content to support what I'm learning at school

4-10 years



To learn more about this and other VTech® products, visit www.vtech.co.uk

INTRODUCTION

Thank you for purchasing the **VTech® Toot-Toot Drivers Drive & Discover Police Car** learning toy!

The **Drive & Discover Police Car** features eight fun learning activities that encourage your baby to learn and explore. Press the three buttons, flip the window, spin the roller and more. Your baby will love to discover and learn!

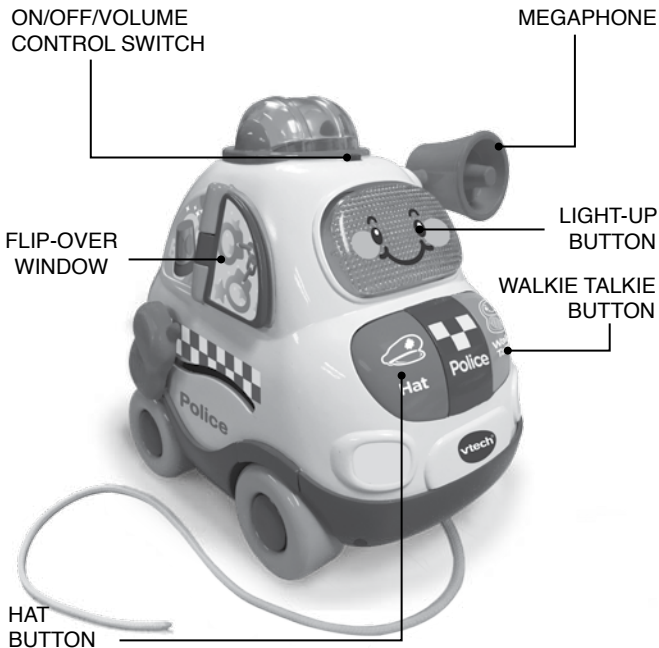

INCLUDED IN THIS PACKAGE

- One VTech® Toot-Toot Drivers Drive & Discover Police Car
- One user's manual

WARNING: All packing materials, such as tape, plastic sheets, wire ties and tags are not part of this toy, and should be discarded for your child's safety.

NOTE: Please keep this instruction manual as it contains important information.

WARNING: The cord is not part of this toy. Please remove the cord and discard before assembly for your child's safety.

Unlock the packaging locks:

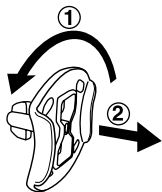

① Rotate the packaging lock anticlockwise 90 degrees

② Pull out the packaging lock.

BATTERY INSTALLATION

1. Make sure the unit is turned OFF.
2. Locate the battery cover on the back of the unit. Use a screwdriver to loosen the screw.
3. Install 2 new AA (AM-3/LR6) batteries following the diagram inside the battery box. (The use of new batteries is recommended for maximum performance.)
4. Replace the battery cover and tighten the screw to secure.

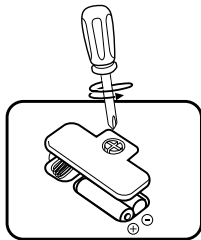

BATTERY NOTICE

- Use new alkaline batteries or fully charged NI-MH (Nickel Metal-hydride) rechargeable batteries for best performance.
- Use only batteries of the same or equivalent type as recommended.
- Do not mix different types of batteries: alkaline, standard (carbon-zinc) or rechargeable (Ni-Cd, Ni-MH), or new and used batteries.
- Do not use damaged batteries.
- Insert batteries with the correct polarity.
- Do not short-circuit the battery terminals.
- Remove exhausted batteries from the toy.
- Remove batteries during long periods of non-use.
- Do not dispose of batteries in fire.
- Do not charge non-rechargeable batteries.
- Remove rechargeable batteries from the toy before charging (if removable).
- Rechargeable batteries are only to be charged under adult supervision.

Disposal of batteries and product



The crossed-out wheellie bin symbols on products and batteries, or on their respective packaging, indicates they must not be disposed of in domestic waste as they contain substances that can be damaging to the environment and human health.



The chemical symbols Hg, Cd or Pb, where marked, indicate that the battery contains more than the specified value of mercury (Hg), cadmium (Cd) or lead (Pb) set out in Battery Directive (2006/66/EC).

The solid bar indicates that the product was placed on the market after 13th August, 2005.

Help protect the environment by disposing of your product or batteries responsibly.

For more information, please visit:

www.recycle-more.co.uk

www.recyclenow.com

PRODUCT FEATURES

1. ON/OFF/VOLUME CONTROL SWITCH

To turn the unit **ON**, turn the **ON/OFF/VOLUME CONTROL SWITCH** to the **LOW VOLUME** (🔊) or the **HIGH VOLUME** (🔊🔊) position. To turn the unit **OFF**, turn the **ON/OFF/VOLUME CONTROL SWITCH** to the **OFF** (●) position.

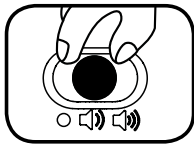

2. PULL CORD

To convert the unit from a push toy to a pull toy, remove the pull cord from the battery compartment and thread it through the eyelet on the bottom of the car. For your child's safety we suggest you store the pull cord in the compartment until your child is walking and to supervise your child when playing with the pull cord.

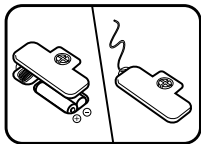

2. AUTOMATIC SHUT OFF

To preserve battery life, the **Toot-Toot Drivers Drive & Discover Police Car** will automatically power-down after approximately 70 seconds without input. The unit can be turned on again by pressing any button. Pushing the car will not turn the unit back on.

NOTE: If the unit powers down quickly while playing, we suggest changing the batteries.

ACTIVITIES

1. Slide the **on/off/volume control switch** to turn the unit on. You will hear a playful song, a fun phrase and a sound. The light will flash with the sounds.

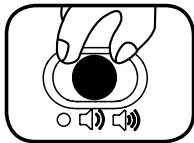

2. Press the **light-up button** to hear car sounds and encouraging phrases. The light will flash with the sounds.



3. Press the **hat button** to hear fun phrases, sounds and learn a colour. The light will flash with the sounds.



4. Press the **walkie talkie button** to hear imitative walkie talkie sounds, imaginative phrases and learn a colour. The light will flash with the sounds.



5. Activate the **megaphone** to hear megaphone sounds and imaginative phrases. The light will flash with the sounds.



6. Turn the **flip-over window** to hear fun sounds and phrases. The light will flash with the sounds.

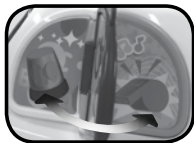

7. Activate the **motion sensor** to hear playful sounds and melodies. When a melody is playing and the motion sensor continues to be activated, you will hear fun sounds and phrases play over the melody. The light will flash with the sounds.



MELODY LIST

1. ABC Tumble Down D
2. Alexander's Ragtime Band
3. A Bicycle Built for Two
4. Chopsticks
5. Clementine
6. For He's a Jolly Good Fellow
7. The Green Grass Grew All Around
8. Hickory Dickory Dock
9. Humpty Dumpty
10. Jack and Jill
11. Jimmy Crack Corn
12. Little Miss Muffet
13. The Daring Young Man on the Flying Trapeze
14. Muffin Man
15. Pease Porridge
16. Peter Peter Pumpkin Eater
17. The Red River Valley
18. Row, Row, Row Your Boat
19. Sing a Song of Sixpence
20. This Old Man

SING ALONG SONG LYRICS

SONG 1

Start the Engine,
Start the day,
Patrolling the streets,
Protecting my Toot-Toot Drivers pals all the way!

SONG 2

Answer the call!
It's my job to enforce the law!

SONG 3

Red light, blue light,
Flashing bright, Helping all day and night.

SONG 4

It's my duty, to protect and serve,
I love being a police officer!

CARE & MAINTENANCE

1. Keep the unit clean by wiping it with a slightly damp cloth.
2. Keep the unit out of direct sunlight and away from any direct heat source.
3. Remove the batteries when the unit will not be in use for an extended period of time.
4. Do not drop the unit on hard surfaces and do not expose the unit to moisture or water.

TROUBLESHOOTING

If for some reason the program/activity stops working, please follow these steps:

1. Please turn the unit **OFF**.
2. Interrupt the power supply by removing the batteries.
3. Let the unit stand for a few minutes, then replace the batteries.
4. Turn the unit **ON**. The unit should now be ready to play again.
5. If the product still does not work, replace with an entire set of new batteries.

If the problem persists, please call our Consumer Services Department on 01235 546810 (from UK) or +44 1235 546810 (outside UK) and a service representative will be happy to help you.

IMPORTANT NOTE:

Creating and developing **VTech®** products is accompanied by a responsibility that we take very seriously. We make every effort to ensure the accuracy of the information, which forms the value of our products. However, errors sometimes can occur. It is important for you to know that we stand behind our products and encourage you to call our Consumer Services Department on 01235 546810 (from UK) or +44 1235 546810 (outside UK), with any problems and/or suggestions that you might have. A service representative will be happy to help you.

CLASS 1
LED PRODUCT



PRODUCT REGISTRATION

Visit www.vtech.co.uk/clubvtech/login
to register your VTech product

By joining the VTech Club you can also enter competitions, find out about news and events, seek expert advice for parents and let your kids play fun learning games and activities.



PRODUCT WARRANTY

Thank you for choosing this quality product from VTech. We hope it will bring many hours of entertainment, imaginative play and learning.

1. The product detailed above is covered by a one year warranty from the date of purchase, against any defects in materials or workmanship.
2. The product may be returned to the place of purchase. Alternatively the product can be returned to VTech Electronics Europe plc (see address below), with proof of purchase, without proof of purchase no replacement will be provided.
3. VTech Electronics Europe plc will examine the product and if it is found to be defective due to faulty materials or workmanship, will replace the product at their discretion.
4. If the product covered by this warranty is damaged due to misuse, modification or unauthorised repair, or because of faulty batteries, battery discharge or incorrect electrical connections, then this warranty becomes void.
5. This warranty is personal to the original purchaser and is not transferable.
6. Breakages to the LCD screen are not covered by the warranty.
7. Returns to VTech Electronics Europe plc should include a cheque or postal order for £1.50 towards the cost of return postage and packaging.
8. Products returned to VTech Electronics Europe plc, should be addressed as follows and packed carefully to avoid damage in transit (Please do not include batteries or adaptor). Please include details of the fault together with your name and address.
9. To keep an online record of your warranty, please register your product online at www.vtech.co.uk/warranty

Vtech Electronics EU PLC, c/o XPO Logistics, Warehouse 350, Cat & Fiddle Lane, West Hallam, DE7 6HE

THIS WARRANTY IS OFFERED AS AN EXTRA BENEFIT AND DOES NOT AFFECT CONSUMERS' STATUTORY RIGHTS.

This warranty is valid for the UK and Eire only. For products purchased outside the UK and Eire, please contact your local distributor or place of purchase.

